

3005020060

STB-5

Flush Mounted Substation

This product will be replaced by the equivalent Phontech solution, but Zenitel will honor prior commitments given to the market. Therefore, we will continue to provide expansion and spare-part service for this product.



Description

- ✓ Talk-Back substation, designed for multipurpose indoor use (engine room)
- ✓ Flush mounting
- ✓ Wall mounting with back box
- ✓ Call button
- ✓ Built-in relay circuit for operating external signalling devices
- ✓ Loudspeaker
- ✓ Socket for handset or handheld microphone

Technical Dimensions

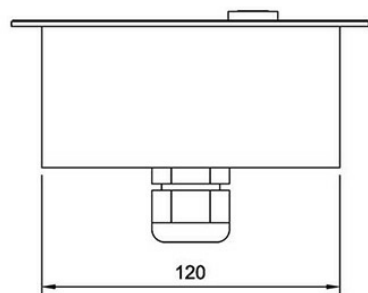
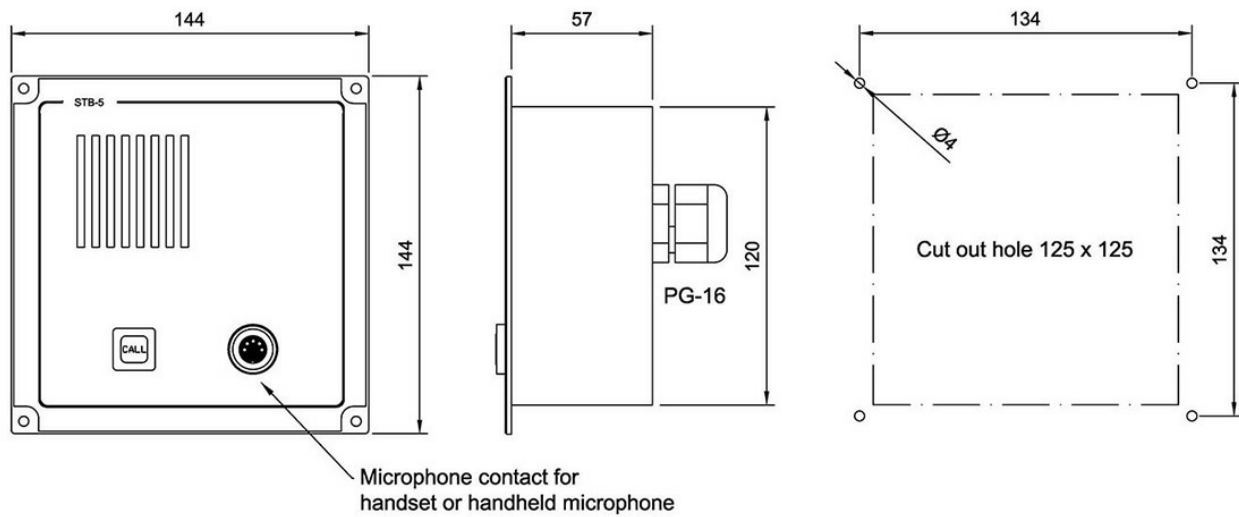

Related items:
 Microphone ETC-STB5 3005020030
 Handset HAS-1 3005020032
 Wall mounting box STBOKS5 3005010206

Specifications

GENERAL

Material / Colour	Aluminium / black
Connections	Screw Terminals
Loudspeaker	3 W
Dimensions (mm)	144W x 144H x 57D
Weight	Approx. 0,5 kg
IP rating	IP-22
Temperature operating	-15 to +55 °C

Accessories

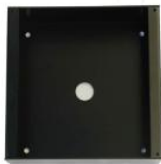

STBOKS5

Wall mounting box for STB-5/5GN



ETC-STB5

Hand Microphone for STB-5



HAS-1

Handset for STB-5